

COMET END SEALING FERRULES (NON-INSULATED & INSULATED)

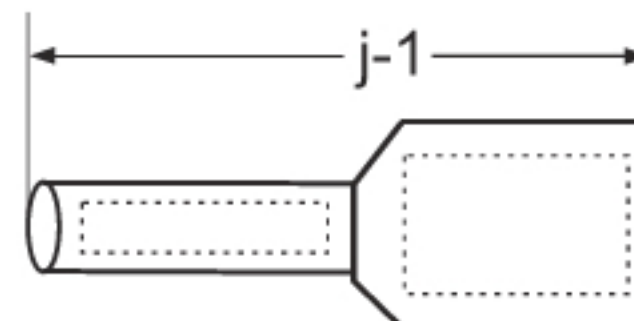
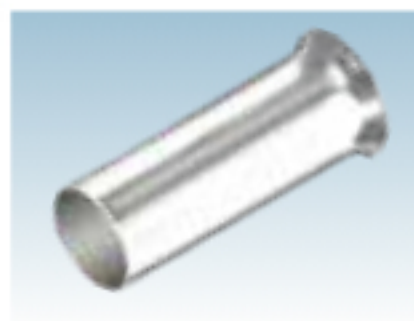
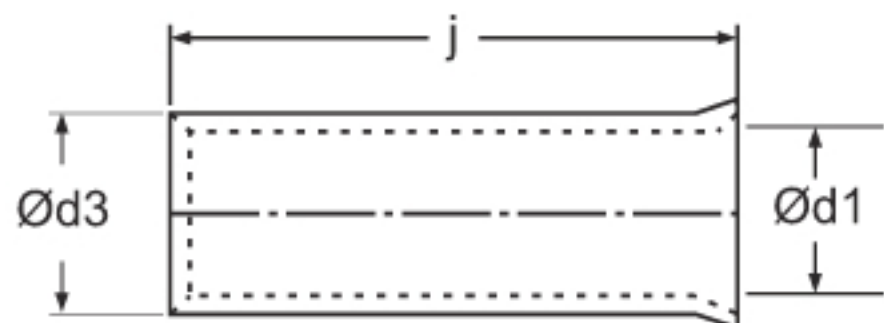

NON - INSULATED

INSULATED

Size mm2	Ød1	Ød3	j	COMET CAT NO.	j-1	COMET CAT NO.
0.5	1.0-1.1	1.4-1.5	6	CEH-508	12	CEHI-508
0.75	1.4-1.5	1.8-1.9	6	CEH-509	12	CEHI-509
1.0	1.6-1.7	2.0-2.1	6	CEH-510	12	CEHI-510
1.0	1.6-1.7	2.0-2.1	10	CEH-511	16	CEHI-511
1.5	1.8-1.9	2.2-2.3	8	CEH-512	14	CEHI-512
1.5	1.8-1.9	2.2-2.3	10	CEH-513	16	CEHI-513
2.5	2.3-2.4	2.7-2.8	8	CEH-514	14	CEHI-514
2.5	2.3-2.4	2.7-2.8	12	CEH-515	18	CEHI-515
4.0	2.8-2.9	3.2-3.3	10	CEH-516	16	CEHI-516
4.0	2.8-2.9	3.2-3.3	12	CEH-517	18	CEHI-517
6.0	3.7-3.8	4.1-4.2	10	CEH-518	18	CEHI-518
6.0	3.7-3.8	4.1-4.2	12	CEH-519	20	CEHI-519
6.0	3.7-3.8	4.1-4.2	15	CEH-520	23	CEHI-520
10	4.6-4.7	5.0-5.1	12	CEH-521	22	CEHI-521
10	4.6-4.7	5.0-5.1	15	CEH-522	25	CEHI-522
10	4.6-4.7	5.0-5.1	18	CEH-523	28	CEHI-523
16	5.9-6.0	6.3-6.4	12	CEH-524	24	CEHI-524
16	5.9-6.0	6.3-6.4	15	CEH-525	27	CEHI-525
16	5.9-6.0	6.3-6.4	18	CEH-526	30	CEHI-526

MATERIAL : COPPER IS - 191

FINISH : ELECTRO TINNED